



PATENTED SPRING LOCKING CLIP FOR THE ROD LOK REFRACTORY ANCHOR



Pressform has extensive experience in the design and manufacture of Refractory Hardware and is a leader in the field. We understand that providing anchor stability during the refractory concreting process is paramount to a fast, safe, successful and therefore cost effective refractory installation. Our patented Spring Locking Clip design ensures anchor arms will always be vertical, avoiding weakened refractory cement support and hot spots.

DESIGN FEATURES

Manufactured from thin spring steel, so that when it reaches service temperature the spring temper dissipates and the anchor arms can move with expansion as intended.

- Serrations on the side of lug provide adjustment for the clip
- Length of the lug can be variable allowing use of cross arm inserts
- Note the holes in the clip enable refractory cement ingress
- The round base of stud weldable lug lends itself to manual welding as well as stud welding
- Lugs can be flat if directional strength is not an issue
- Round lugs have the same strength in all directions
- Anchor wires can have a parallel section similar to PFVS anchors for thicker refractory anchoring

COST

The spring steel clip and serration of the lug - \$2.00

Or receive a reduced price with any order of new anchors and lugs.

HOW IT WORKS

These illustrations show how the arms of a Rod Lock Anchor can be locked in the upright position as a fail safe.

11. Steel or stainless steel slotted base
12. 8mm or 10mm diameter wire anchor arm
17. Rounded top edge
18. Clip engaging slots
51. Spring steel locking clip

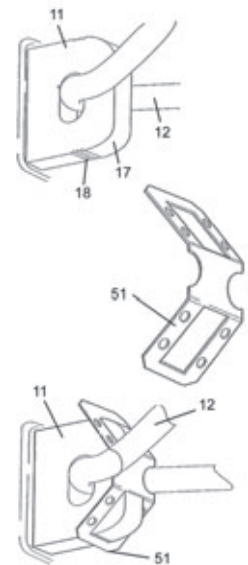

ALSO AVAILABLE: THE STUD WELDABLE LUG

Carbon Steel
Stainless Steel
Nickel Alloys



Ask us
how you can
install your anchors
safely, securely and 10
times faster with the
revolutionary Pressform
Stud Welding
System.



ORDER NOW

To order, or to discuss your requirements,
contact Pressform Engineering
+61 8 9279 8855
sales@pressform.com.au
www.pressform.com.au